

COLLECT, STRIP, ASSESS AND REPAIR WELDING MACHINES ON AN AS AND WHEN REQUIRED BASIS AT ARNOT POWER STATION FOR A PERIOD OF 36 MONTHS**NEC3 Term Service Contract (TSC3)**

**Between ESKOM HOLDINGS SOC Ltd
(Reg No. 2002/015527/30)**

**and [Insert at award stage]
(Reg No. _____)**

**for The assessment and repairs of welding machines at
Arnot power station for a period of 60 months**

Contents:	No of pages
Part C1 Agreements & Contract Data	[•]
Part C2 Pricing Data	[•]
Part C3 Scope of Work	[•]

CONTRACT No. [Insert at award stage]

COLLECT, STRIP, ASSESS AND REPAIR WELDING MACHINES ON AN AS AND WHEN REQUIRED BASIS AT ARNOT POWER STATION FOR A PERIOD OF 36 MONTHS**PART C1: AGREEMENTS & CONTRACT DATA**

Contents:	No of pages
C1.1 Form of Offer and Acceptance	[•]
[to be inserted from Returnable Documents at award stage]	
C1.2a Contract Data provided by the <i>Employer</i>	[•]
C1.2b Contract Data provided by the <i>Contractor</i>	[•]
[to be inserted from Returnable Documents at award stage]	
C1.3 Proforma Guarantees	[•]

COLLECT, STRIP, ASSESS AND REPAIR WELDING MACHINES ON AN AS AND WHEN REQUIRED BASIS AT ARNOT POWER STATION FOR A PERIOD OF 36 MONTHS

C1.1 Form of Offer & Acceptance

Offer

The Employer, identified in the Acceptance signature block, has solicited offers to enter into a contract for the procurement of:

Title of the Contract

The tenderer, identified in the Offer signature block, has examined the documents listed in the Tender Data and addenda thereto and by submitting this Offer has accepted the Conditions of Tender.

By the representative of the tenderer, deemed to be duly authorised, signing this part of this Form of Offer and Acceptance the tenderer offers to perform all of the obligations and liabilities of the *Contractor* under the contract including compliance with all its terms and conditions according to their true intent and meaning for an amount to be determined in accordance with the *conditions of contract* identified in the Contract Data.

Options A	The offered total of the Prices exclusive of VAT is	R
	Sub total	R
	Value Added Tax @ 15% is	R
	The offered total of the amount due inclusive of VAT is ¹	R
	(in words)	

This Offer may be accepted by the Employer by signing the Acceptance part of this Form of Offer and Acceptance and returning one copy of this document including the Schedule of Deviations (if any) to the tenderer before the end of the period of validity stated in the Tender Data, or other period as agreed, whereupon the tenderer becomes the party named as the *Contractor* in the *conditions of contract* identified in the Contract Data.

Signature(s)

Name(s)

Capacity

**For the
tenderer:**

(Insert name and address of organisation)

Name &
signature of
witness

Date

Tenderer's CIDB registration number:

¹ This total is required by the *Employer* for budgeting purposes only. Actual amounts due will be assessed in terms of the *conditions of contract*.

COLLECT, STRIP, ASSESS AND REPAIR WELDING MACHINES ON AN AS AND WHEN REQUIRED BASIS AT ARNOT POWER STATION FOR A PERIOD OF 36 MONTHS

Acceptance

By signing this part of this Form of Offer and Acceptance, the Employer identified below accepts the tenderer's Offer. In consideration thereof, the Employer shall pay the Contractor the amount due in accordance with the *conditions of contract* identified in the Contract Data. Acceptance of the tenderer's Offer shall form an agreement between the Employer and the tenderer upon the terms and conditions contained in this agreement and in the contract that is the subject of this agreement.

The terms of the contract, are contained in:

Part C1	Agreements and Contract Data, (which includes this Form of Offer and Acceptance)
Part C2	Pricing Data
Part C3	Scope of Work: Service Information

and drawings and documents (or parts thereof), which may be incorporated by reference into the above listed Parts.

Deviations from and amendments to the documents listed in the Tender Data and any addenda thereto listed in the Returnable Schedules as well as any changes to the terms of the Offer agreed by the tenderer and the Employer during this process of offer and acceptance, are contained in the Schedule of Deviations attached to and forming part of this Form of Offer and Acceptance. No amendments to or deviations from said documents are valid unless contained in this Schedule.

The tenderer shall within two weeks of receiving a completed copy of this agreement, including the Schedule of Deviations (if any), contact the Employer's agent (whose details are given in the Contract Data) to arrange the delivery of any securities, bonds, guarantees, proof of insurance and any other documentation to be provided in terms of the *conditions of contract* identified in the Contract Data at, or just after, the date this agreement comes into effect. Failure to fulfil any of these obligations in accordance with those terms shall constitute a repudiation of this agreement.

Notwithstanding anything contained herein, this agreement comes into effect on the date when the tenderer receives one fully completed and signed original copy of this document, including the Schedule of Deviations (if any).

Signature(s)

Name(s)

Capacity

**for the
Employer**

(Insert name and address of organisation)

Name &
signature of
witness

Date

Note: If a tenderer wishes to submit alternative tenders, use another copy of this Form of Offer and Acceptance.

COLLECT, STRIP, ASSESS AND REPAIR WELDING MACHINES ON AN AS AND WHEN REQUIRED BASIS AT ARNOT POWER STATION FOR A PERIOD OF 36 MONTHS

Schedule of Deviations to be completed by the *Employer* prior to contract award

Note:

1. This part of the Offer & Acceptance would not be required if the contract has been developed by negotiation between the Parties and is not the result of a process of competitive tendering.
2. The extent of deviations from the tender documents issued by the Employer prior to the tender closing date is limited to those permitted in terms of the Conditions of Tender.
3. A tenderer's covering letter must not be included in the final contract document. Should any matter in such letter, which constitutes a deviation as aforesaid be the subject of agreement reached during the process of Offer and Acceptance, the outcome of such agreement shall be recorded here and the final draft of the contract documents shall be revised to incorporate the effect of it.

No.	Subject	Details
1	[•]	[•]
2	[•]	[•]
3	[•]	[•]
4	[•]	[•]
5	[•]	[•]
6	[•]	[•]
7	[•]	[•]

By the duly authorised representatives signing this Schedule of Deviations below, the Employer and the tenderer agree to and accept this Schedule of Deviations as the only deviations from and amendments to the documents listed in the Tender Data and any addenda thereto listed in the Tender Schedules, as well as any confirmation, clarification or changes to the terms of the Offer agreed by the tenderer and the Employer during this process of Offer and Acceptance.

It is expressly agreed that no other matter whether in writing, oral communication or implied during the period between the issue of the tender documents and the receipt by the tenderer of a completed signed copy of this Form shall have any meaning or effect in the contract between the parties arising from this Agreement.

For the tenderer:

For the Employer

Signature

Name

Capacity

On behalf
of

(Insert name and address of organisation)

(Insert name and address of organisation)

Name &
signature
of witness

Date

COLLECT, STRIP, ASSESS AND REPAIR WELDING MACHINES ON AN AS AND WHEN REQUIRED BASIS AT ARNOT POWER STATION FOR A PERIOD OF 36 MONTHS

C1.2 TSC3 Contract Data

Part one - Data provided by the *Employer*

Clause	Statement	Data
1	General	
	The <i>conditions of contract</i> are the core clauses and the clauses for main Option:	
		A: Priced contract with price list
	dispute resolution Option	W1: Dispute resolution procedure
	and secondary Options	
		X1: Price adjustment for inflation
		X2 Changes in the law
		X17: Low service damages
		X18: Limitation of liability
		X19: Task Order
		Z: Additional conditions of contract
	of the NEC3 Term Service Contract April 2013 ² (TSC3)	
10.1	The <i>Employer</i> is (name):	Eskom Holdings SOC Ltd (reg no: 2002/015527/30), a state owned company incorporated in terms of the company laws of the Republic of South Africa
	Address	Registered office at Megawatt Park, Maxwell Drive, Sandton, Johannesburg
	Tel No.	Not applicable
	Fax No.	Not applicable
10.1	The <i>Service Manager</i> is (name):	Siphiwe Nkosi
	Address	Private Bag X2, Rietkuil
	Tel	013 297 9787
	Fax	
	e-mail	nkosisw@eskom.co.za
11.2(2)	The Affected Property is	Welding Machines

² Available from Engineering Contract Strategies Tel 011 803 3008 Fax 086 539 1902 www.ecs.co.za

COLLECT, STRIP, ASSESS AND REPAIR WELDING MACHINES ON AN AS AND WHEN REQUIRED BASIS AT ARNOT POWER STATION FOR A PERIOD OF 36 MONTHS

11.2(13)	The <i>service</i> is	Assessment and repairs of welding machines at Arnot power station for a period of 36 months
11.2(14)	The following matters will be included in the Risk Register	Scope Quality Time
11.2(15)	The Service Information is in	Part 3: Scope of Work and all documents and drawings to which it makes reference.
12.2	The <i>law of the contract</i> is the law of	the Republic of South Africa
13.1	The <i>language of this contract</i> is	English
13.3	The <i>period for reply</i> is	4 weeks
2	The Contractor's main responsibilities	Data required by this section of the core clauses is also provided by the <i>Contractor</i> in Part 2 and terms in italics used in this section are identified elsewhere in this Contract Data
21.1	The <i>Contractor</i> submits a first plan for acceptance within	2 weeks of the Contract Date
3	Time	
30.1	The <i>starting date</i> is.	01 December 2023
30.1	The <i>service period</i> is	3 Years
4	Testing and defects	1 month warranty on all repaired welding machines and 12 months on new machines
5	Payment	
50.1	The <i>assessment interval</i> is	After each delivery subject to approval of quality check and visual inspection
51.1	The <i>currency of this contract</i> is the	South African Rand
51.2	The period within which payments are made is	2 weeks after receipt of a valid tax invoice
51.4	The <i>interest rate</i> is	<p>the publicly quoted prime rate of interest (calculated on a 365 day year) charged by from time to time by the Standard Bank of South Africa Limited (as certified, in the event of any dispute, by any manager of such bank, whose appointment it shall not be necessary to prove) for amounts due in Rands and</p> <p>(ii) the LIBOR rate applicable at the time for amounts due in other currencies. LIBOR is the 6 month London Interbank Offered Rate quoted under the caption "Money Rates" in The Wall Street Journal for the applicable currency or if no rate is quoted for the currency in question then the rate for United States Dollars, and if no</p>

COLLECT, STRIP, ASSESS AND REPAIR WELDING MACHINES ON AN AS AND WHEN REQUIRED BASIS AT ARNOT POWER STATION FOR A PERIOD OF 36 MONTHS

such rate appears in The Wall Street Journal then the rate as quoted by the Reuters Monitor Money Rates Service (or such service as may replace the Reuters Monitor Money Rates Service) on the due date for the payment in question, adjusted *mutatis mutandis* every 6 months thereafter (and as certified, in the event of any dispute, by any manager employed in the foreign exchange department of The Standard Bank of South Africa Limited, whose appointment it shall not be necessary to prove.

6	Compensation events	There is no reference to Contract Data in this section of the core clauses and terms in italics used in this section are identified elsewhere in this Contract Data
7	Use of Equipment Plant and Materials	There is no reference to Contract Data in this section of the core clauses and terms in italics used in this section are identified elsewhere in this Contract Data
8	Risks and insurance	
80.1	These are additional <i>Employer's</i> risks	Lead time
9	Termination	There is no reference to Contract Data in this section of the core clauses and terms in italics used in this section are identified elsewhere in this Contract Data.
10	Data for main Option clause	
A	Priced contract with price list	
20.5	The <i>Contractor</i> prepares forecasts of the final total of the Prices for the whole of the <i>service</i> at intervals no longer than	[4] weeks.
11	Data for Option W1	
W1.1	The <i>Adjudicator</i>	the person selected from the ICE-SA Division (or its successor body) of the South African Institution of Civil Engineering Panel of Adjudicators by the Party intending to refer a dispute to him. (see www.ice-sa.org.za). If the Parties do not agree on an Adjudicator the Adjudicator will be appointed by the Arbitration Foundation of Southern Africa (AFSA).
	Address	[•]
	Tel No.	[•]

COLLECT, STRIP, ASSESS AND REPAIR WELDING MACHINES ON AN AS AND WHEN REQUIRED BASIS AT ARNOT POWER STATION FOR A PERIOD OF 36 MONTHS

Fax No. [•]

e-mail [•]

W1.2(3)	The <i>Adjudicator nominating body</i> is:	the Chairman of ICE-SA a joint Division of the South African Institution of Civil Engineering and the Institution of Civil Engineers (London) (see www.ice-sa.org.za) or its successor body.
W1.4(2)	The <i>tribunal</i> is:	arbitration
W1.4(5)	The <i>arbitration procedure</i> is	the latest edition of Rules for the Conduct of Arbitrations published by The Association of Arbitrators (Southern Africa) or its successor body.
	The place where arbitration is to be held is	[•] South Africa
	The person or organisation who will choose an arbitrator	
	- if the Parties cannot agree a choice or	
	- if the arbitration procedure does not state who selects an arbitrator, is	the Chairman for the time being or his nominee of the Association of Arbitrators (Southern Africa) or its successor body.

12 Data for secondary Option clauses

X1	Price adjustment for inflation			
X1.1	The <i>base date</i> for indices is	[•].		
	The proportions used to calculate the Price Adjustment Factor are:	proportion	linked to index for	Index prepared by
		0.	[•]	[•]
		0.	[•]	[•]
		0.	[•]	[•]
		0.	[•]	[•]
		0.	[•]	[•]
		[•]	non-adjustable	
		1.00		
X2	Changes in the law	There is no reference to Contract Data in this Option and terms in italics are identified elsewhere in this Contract Data.		
X17	Low service damages			
X17.1	The <i>service level table</i> is in 1% of			

COLLECT, STRIP, ASSESS AND REPAIR WELDING MACHINES ON AN AS AND WHEN REQUIRED BASIS AT ARNOT POWER STATION FOR A PERIOD OF 36 MONTHS

	<p>the value of the total task order per day</p> <p>Delay damages for starting and - completion of task Not responding to defects on time</p>	
X18	Limitation of liability	
X18.1	The <i>Contractor's</i> liability to the <i>Employer</i> for indirect or consequential loss is limited to	R0.0 (zero Rand)
X18.2	For any one event, the <i>Contractor's</i> liability to the <i>Employer</i> for loss of or damage to the <i>Employer's</i> property is limited to	the amount of the deductibles relevant to the event
X18.3	The <i>Contractor's</i> liability for Defects due to his design of an item of Equipment is limited to	<p>The greater of</p> <ul style="list-style-type: none"> the total of the Prices at the Contract Date and the amounts excluded and unrecoverable from the <i>Employer's</i> insurance (other than the resulting physical damage to the <i>Employer's</i> property which is not excluded) plus the applicable deductibles
X18.4	The <i>Contractor's</i> total liability to the <i>Employer</i> , for all matters arising under or in connection with this contract, other than the excluded matters, is limited to	<p>the total of the Prices other than for the additional excluded matters.</p> <p>The <i>Contractor's</i> total liability for the additional excluded matters is not limited.</p> <p>The additional excluded matters are amounts for which the <i>Contractor</i> is liable under this contract for</p> <ul style="list-style-type: none"> Defects due to his design, plan and specification, Defects due to manufacture and fabrication outside the Affected Property, loss of or damage to property (other than the <i>Employer's</i> property, Plant and Materials), death of or injury to a person and infringement of an intellectual property right.
X18.5	The <i>end of liability date</i> is	12 months after the end of the <i>service period</i>.
X19	Task Order	
X19.5	The <i>Contractor</i> submits a Task Order programme to the <i>Service Manager</i> within	5 days of receiving the Task Order
Z	The <i>additional conditions of contract</i> are	Z1 to Z14 always apply.

COLLECT, STRIP, ASSESS AND REPAIR WELDING MACHINES ON AN AS AND WHEN REQUIRED BASIS AT ARNOT POWER STATION FOR A PERIOD OF 36 MONTHS**Z1 Cession delegation and assignment**

- Z1.1 The *Contractor* does not cede, delegate or assign any of its rights or obligations to any person without the written consent of the *Employer*.
- Z1.2 Notwithstanding the above, the *Employer* may on written notice to the *Contractor* cede and delegate its rights and obligations under this contract to any of its subsidiaries or any of its present divisions or operations which may be converted into separate legal entities as a result of the restructuring of the Electricity Supply Industry.

Z2 Joint ventures

- Z2.1 If the *Contractor* constitutes a joint venture, consortium or other unincorporated grouping of two or more persons or organisations then these persons or organisations are deemed to be jointly and severally liable to the *Employer* for the performance of this contract.
- Z2.2 Unless already notified to the *Employer*, the persons or organisations notify the *Service Manager* within two weeks of the Contract Date of the key person who has the authority to bind the *Contractor* on their behalf.
- Z2.3 The *Contractor* does not alter the composition of the joint venture, consortium or other unincorporated grouping of two or more persons without the consent of the *Employer* having been given to the *Contractor* in writing.

Z3 Change of Broad Based Black Economic Empowerment (B-BBEE) status

- Z3.1 Where a change in the *Contractor's* legal status, ownership or any other change to his business composition or business dealings results in a change to the *Contractor's* B-BBEE status, the *Contractor* notifies the *Employer* within seven days of the change.
- Z3.2 The *Contractor* is required to submit an updated verification certificate and necessary supporting documentation confirming the change in his B-BBEE status to the *Service Manager* within thirty days of the notification or as otherwise instructed by the *Service Manager*.
- Z3.3 Where, as a result, the *Contractor's* B-BBEE status has decreased since the Contract Date the *Employer* may either re-negotiate this contract or alternatively, terminate the *Contractor's* obligation to Provide the Service.
- Z3.4 Failure by the *Contractor* to notify the *Employer* of a change in its B-BBEE status may constitute a reason for termination. If the *Employer* terminates in terms of this clause, the procedures on termination are P1, P2 and P4 as stated in clause 92, and the amount due is A1 and A3 as stated in clause 93.

Z4 Confidentiality

- Z4.1 The *Contractor* does not disclose or make any information arising from or in connection with this contract available to Others. This undertaking does not, however, apply to information which at the time of disclosure or thereafter, without default on the part of the *Contractor*, enters the public domain or to information which was already in the possession of the *Contractor* at the time of disclosure (evidenced by written records in existence at that time). Should the *Contractor* disclose information to Others in terms of clause 25.1, the *Contractor* ensures that the provisions of this clause are complied with by the recipient.
- Z4.2 If the *Contractor* is uncertain about whether any such information is confidential, it is to be regarded as such until notified otherwise by the *Service Manager*.

COLLECT, STRIP, ASSESS AND REPAIR WELDING MACHINES ON AN AS AND WHEN REQUIRED BASIS AT ARNOT POWER STATION FOR A PERIOD OF 36 MONTHS

- Z4.3 In the event that the *Contractor* is, at any time, required by law to disclose any such information which is required to be kept confidential, the *Contractor*, to the extent permitted by law prior to disclosure, notifies the *Employer* so that an appropriate protection order and/or any other action can be taken if possible, prior to any disclosure. In the event that such protective order is not, or cannot, be obtained, then the *Contractor* may disclose that portion of the information which it is required to be disclosed by law and uses reasonable efforts to obtain assurances that confidential treatment will be afforded to the information so disclosed.
- Z4.4 The taking of images (whether photographs, video footage or otherwise) of the Affected Property or any portion thereof, in the course of Providing the Service and after the end of the *service period*, requires the prior written consent of the *Service Manager*. All rights in and to all such images vests exclusively in the *Employer*.
- Z4.5 The *Contractor* ensures that all his subcontractors abide by the undertakings in this clause.

Z5 Waiver and estoppel: Add to core clause 12.3:

- Z5.1 Any extension, concession, waiver or relaxation of any action stated in this contract by the Parties, the *Service Manager* or the *Adjudicator* does not constitute a waiver of rights, and does not give rise to an estoppel unless the Parties agree otherwise and confirm such agreement in writing.

Z6 Health, safety and the environment: Add to core clause 27.4

- Z6.1 The *Contractor* undertakes to take all reasonable precautions to maintain the health and safety of persons in and about the execution of the *service*. Without limitation the *Contractor*:
- accepts that the *Employer* may appoint him as the "Principal Contractor" (as defined and provided for under the Construction Regulations 2014 (promulgated under the Occupational Health & Safety Act 85 of 1993) ("the Construction Regulations") for the Affected Property;
 - warrants that the total of the Prices as at the Contract Date includes a sufficient amount for proper compliance with the Construction Regulations, all applicable health & safety laws and regulations and the health and safety rules, guidelines and procedures provided for in this contract and generally for the proper maintenance of health & safety in and about the execution of the *service*; and
 - undertakes, in and about the execution of the *service*, to comply with the Construction Regulations and with all applicable health & safety laws and regulations and rules, guidelines and procedures otherwise provided for under this contract and ensures that his Subcontractors, employees and others under the *Contractor's* direction and control, likewise observe and comply with the foregoing.
- Z6.2 The *Contractor*, in and about the execution of the *service*, complies with all applicable environmental laws and regulations and rules, guidelines and procedures otherwise provided for under this contract and ensures that his Subcontractors, employees and others under the *Contractor's* direction and control, likewise observe and comply with the foregoing.

Z7 Provision of a Tax Invoice and interest. Add to core clause 51

- Z7.1 Within one week of receiving a payment certificate from the *Service Manager* in terms of core clause 51.1, the *Contractor* provides the *Employer* with a tax invoice in accordance with the *Employer's* procedures stated in the Service Information, showing the amount due for payment equal to that stated in the payment certificate.
- Z7.2 If the *Contractor* does not provide a tax invoice in the form and by the time required by this contract, the time by when the *Employer* is to make a payment is extended by a period equal in

COLLECT, STRIP, ASSESS AND REPAIR WELDING MACHINES ON AN AS AND WHEN REQUIRED BASIS AT ARNOT POWER STATION FOR A PERIOD OF 36 MONTHS

time to the delayed submission of the correct tax invoice. Interest due by the *Employer* in terms of core clause 51.2 is then calculated from the delayed date by when payment is to be made.

- Z7.3 The *Contractor* (if registered in South Africa in terms of the companies Act) is required to comply with the requirements of the Value Added Tax Act, no 89 of 1991 (as amended) and to include the *Employer's* VAT number 4740101508 on each invoice he submits for payment.

Z8 Notifying compensation events

- Z8.1 Delete the last paragraph of core clause 61.3 and replace with:

If the *Contractor* does not notify a compensation event within eight weeks of becoming aware of the event, he is not entitled to a change in the Prices.

Z9 Employer's limitation of liability

- Z9.1 The *Employer's* liability to the *Contractor* for the *Contractor's* indirect or consequential loss is limited to R0.00 (zero Rand)
- Z9.2 The *Contractor's* entitlement under the indemnity in 82.1 is provided for in 60.1(12) and the *Employer's* liability under the indemnity is limited to compensation as provided for in core clause 63 and X19.11 if Option X19 Task Order applies to this contract.

Z10 Termination: Add to core clause 91.1, at the second main bullet point, fourth sub-bullet point, after the words "against it":

- Z10.1 or had a business rescue order granted against it.

Z11 Ethics

For the purposes of this Z-clause, the following definitions apply:

Affected Party means, as the context requires, any party, irrespective of whether it is the *Contractor* or a third party, such party's employees, agents, or Subcontractors or Subcontractor's employees, or any one or more of all of these parties' relatives or friends,

Coercive Action means to harm or threaten to harm, directly or indirectly, an Affected Party or the property of an Affected Party, or to otherwise influence or attempt to influence an Affected Party to act unlawfully or illegally,

Collusive Action means where two or more parties co-operate to achieve an unlawful or illegal purpose, including to influence an Affected Party to act unlawfully or illegally,

Committing Party means, as the context requires, the *Contractor*, or any member thereof in the case of a joint venture, or its employees, agents, or Subcontractors or the Subcontractor's employees,

Corrupt Action means the offering, giving, taking, or soliciting, directly or indirectly, of a good or service to unlawfully or illegally influence the actions of an Affected Party,

Fraudulent Action means any unlawfully or illegally intentional act or omission that misleads, or attempts to mislead, an Affected Party, in order to obtain a financial or other benefit or to avoid an obligation or incurring an obligation,

Obstructive means a Committing Party unlawfully or illegally destroying, falsifying, altering or

COLLECT, STRIP, ASSESS AND REPAIR WELDING MACHINES ON AN AS AND WHEN REQUIRED BASIS AT ARNOT POWER STATION FOR A PERIOD OF 36 MONTHS

Action concealing information or making false statements to materially impede an investigation into allegations of Prohibited Action, and

Prohibited Action means any one or more of a Coercive Action, Collusive Action Corrupt Action, Fraudulent Action or Obstructive Action.

Z11.1 A Committing Party may not take any Prohibited Action during the course of the procurement of this contract or in execution thereof.

Z11.2 The *Employer* may terminate the *Contractor's* obligation to Provide the Services if a Committing Party has taken such Prohibited Action and the *Contractor* did not take timely and appropriate action to prevent or remedy the situation, without limiting any other rights or remedies the *Employer* has. It is not required that the Committing Party had to have been found guilty, in court or in any other similar process, of such Prohibited Action before the *Employer* can terminate the *Contractor's* obligation to Provide the Services for this reason.

Z11.3 If the *Employer* terminates the *Contractor's* obligation to Provide the Services for this reason, the amounts due on termination are those intended in core clauses 92.1 and 92.2.

Z11.4 A Committing Party co-operates fully with any investigation pursuant to alleged Prohibited Action. Where the *Employer* does not have a contractual bond with the Committing Party, the *Contractor* ensures that the Committing Party co-operates fully with an investigation.

Z12 Insurance

Z 12 .1 Replace core clause 83 with the following:

Insurance cover 83

- 83.1 When requested by a Party, the other Party provides certificates from his insurer or broker stating that the insurances required by this contract are in force.
- 83.2 The *Contractor* provides the insurances stated in the Insurance Table A from the *starting date* until the earlier of Completion and the date of the termination certificate.

INSURANCE TABLE A

Insurance against	Minimum amount of cover or minimum limit of indemnity
Loss of or damage caused by the <i>Contractor</i> to the <i>Employer's</i> property	The replacement cost where not covered by the <i>Employer's</i> insurance. The <i>Employer's</i> policy deductible as at Contract Date, where covered by the <i>Employer's</i> insurance.
Loss of or damage to Plant and Materials	The replacement cost where not covered by the <i>Employer's</i> insurance. The <i>Employer's</i> policy deductible as at Contract Date, where covered by the <i>Employer's</i> insurance.
Loss of or damage to Equipment	The replacement cost where not covered by the <i>Employer's</i> insurance.

COLLECT, STRIP, ASSESS AND REPAIR WELDING MACHINES ON AN AS AND WHEN REQUIRED BASIS AT ARNOT POWER STATION FOR A PERIOD OF 36 MONTHS

	The <i>Employer's</i> policy deductible as at Contract Date, where covered by the <i>Employer's</i> insurance.
The <i>Contractor's</i> liability for loss of or damage to property (except the <i>Employer's</i> property, Plant and Materials and Equipment) and liability for bodily injury to or death of a person (not an employee of the <i>Contractor</i>) arising from or in connection with the <i>Contractor's</i> Providing the Service	<p><u>Loss of or damage to property</u> The replacement cost</p> <p><u>Bodily injury to or death of a person</u> The amount required by the applicable law.</p>
Liability for death of or bodily injury to employees of the <i>Contractor</i> arising out of and in the course of their employment in connection with this contract	The amount required by the applicable law

Z 12.2 Replace core clause 86 with the following:

Insurance by the Employer

86

86.1 The *Employer* provides the insurances stated in the Insurance Table B

INSURANCE TABLE B

Insurance against or name of policy	Minimum amount of cover or minimum limit of indemnity
Assets All Risk	Per the insurance policy document
Contract Works insurance	Per the insurance policy document
Environmental Liability	Per the insurance policy document
General and Public Liability	Per the insurance policy document
Transportation (Marine)	Per the insurance policy document
Motor Fleet and Mobile Plant	Per the insurance policy document
Terrorism	Per the insurance policy document
Cyber Liability	Per the insurance policy document
Nuclear Material Damage and Business Interruption	Per the insurance policy document
Nuclear Material Damage Terrorism	Per the insurance policy document

COLLECT, STRIP, ASSESS AND REPAIR WELDING MACHINES ON AN AS AND WHEN REQUIRED BASIS AT ARNOT POWER STATION FOR A PERIOD OF 36 MONTHS

Z13 Nuclear Liability

- Z13.1 The *Employer* is the operator of the Koeberg Nuclear Power Station (KNPS), a nuclear installation, as designated by the National Nuclear Regulator of the Republic of South Africa, and is the holder of a nuclear licence in respect of the KNPS.
- Z13.2 The *Employer* is solely responsible for and indemnifies the *Contractor* or any other person against any and all liabilities which the *Contractor* or any person may incur arising out of or resulting from nuclear damage, as defined in Act 44 of 1999, save to the extent that any liabilities are incurred due to the unlawful intent of the *Contractor* or any other person or the presence of the *Contractor* or that person or any property of the *Contractor* or such person at or in the KNPS or on the KNPS site, without the permission of the *Employer* or of a person acting on behalf of the *Employer*.
- Z13.3 Subject to clause Z13.4 below, the *Employer* waives all rights of recourse, arising from the aforesaid, save to the extent that any claims arise or liability is incurred due or attributable to the unlawful intent of the *Contractor* or any other person, or the presence of the *Contractor* or that person or any property of the *Contractor* or such person at or in the KNPS or on the KNPS site, without the permission of the *Employer* or of a person acting on behalf of the *Employer*.
- Z13.4 The *Employer* does not waive its rights provided for in section 30 (7) of Act 44 of 1999, or any replacement section dealing with the same subject matter.
- Z13.5 The protection afforded by the provisions hereof shall be in effect until the KNPS is decommissioned.

Z14 Asbestos

For the purposes of this Z-clause, the following definitions apply:

AAIA	means approved asbestos inspection authority.
ACM	means asbestos containing materials.
AL	means action level, i.e. a level of 50% of the OEL, i.e. 0.1 regulated asbestos fibres per ml of air measured over a 4 hour period. The value at which proactive actions is required in order to control asbestos exposure to prevent exceeding the OEL.
Ambient Air	means breathable air in area of work with specific reference to breathing zone, which is defined to be a virtual area within a radius of approximately 30cm from the nose inlet.
Compliance Monitoring	means compliance sampling used to assess whether or not the personal exposure of workers to regulated asbestos fibres is in compliance with the Standard's requirements for safe processing, handling, storing, disposal and phase-out of asbestos and asbestos containing material, equipment and articles.
OEL	means occupational exposure limit.
Parallel Measurements	means measurements performed in parallel, yet separately, to existing measurements to verify validity of results.
Safe Levels	means airborne asbestos exposure levels conforming to the Standard's requirements for safe processing, handling, storing, disposal and phase-out of asbestos and asbestos containing material, equipment and articles.
Standard	means the <i>Employer's</i> Asbestos Standard 32-303: Requirements for Safe Processing, Handling, Storing, Disposal and Phase-out of Asbestos and Asbestos Containing

COLLECT, STRIP, ASSESS AND REPAIR WELDING MACHINES ON AN AS AND WHEN REQUIRED BASIS AT ARNOT POWER STATION FOR A PERIOD OF 36 MONTHS

Material, Equipment and Articles.

SANAS

means the South African National Accreditation System.

TWA

means the average exposure, within a given workplace, to airborne asbestos fibres, normalised to the baseline of a 4 hour continuous period, also applicable to short term exposures, i.e. 10-minute TWA.

- Z14.1 The *Employer* ensures that the Ambient Air in the area where the *Contractor* will Provide the Services conforms to the acceptable prescribed South African standard for asbestos, as per the regulations published in GNR 155 of 10 February 2002, under the Occupational Health and Safety Act, 1993 (Act 85 of 1993) ("Asbestos Regulations"). The OEL for asbestos is 0.2 regulated asbestos fibres per millilitre of air as a 4-hour TWA, averaged over any continuous period of four hours, and the short term exposure limit of 0.6 regulated asbestos fibres per millilitre of air as a 10-minute TWA, averaged over any 10 minutes, measured in accordance with HSG248 and monitored according to HSG173 and OESSM.
- Z14.2 Upon written request by the *Contractor*, the *Employer* certifies that these conditions prevail. All measurements and reporting are effected by an independent, competent, and certified occupational hygiene inspection body, i.e. a SANAS accredited and Department of Employment and Labour approved AAIA. The *Contractor* may perform Parallel Measurements and related control measures at the *Contractor's* expense. For the purposes of compliance the results generated from Parallel Measurements are evaluated only against South African statutory limits as detailed in clause Z14.1. Control measures conform to the requirements stipulated in the AAIA-approved asbestos work plan.
- Z14.3 The *Employer* manages asbestos and ACM according to the Standard.
- Z14.4 In the event that any asbestos is identified while Providing the Services, a risk assessment is conducted and if so required, with reference to possible exposure to an airborne concentration of above the AL for asbestos, immediate control measures are implemented and relevant air monitoring conducted in order to declare the area safe.
- Z14.5 The *Contractor's* personnel are entitled to stop working and leave the contaminated area forthwith until such time that the area of concern is declared safe by either Compliance Monitoring or an AAIA approved control measure intervention, for example, per the emergency asbestos work plan, if applicable.
- Z14.6 The *Contractor* continues to Provide the Services, without additional control measures presented, on presentation of Safe Levels. The contractually agreed dates to Provide the Services, including the Completion Date, are adjusted accordingly. The contractually agreed dates are extended by the notification periods required by regulations 3 and 21 of the Asbestos Regulations, 2001.
- Z14.7 Any removal and disposal of asbestos, asbestos containing materials and waste, is done by a registered asbestos contractor, instructed by the *Employer* at the *Employer's* expense, and conducted in line with South African legislation.

COLLECT, STRIP, ASSESS AND REPAIR WELDING MACHINES ON AN AS AND WHEN REQUIRED BASIS AT ARNOT POWER STATION FOR A PERIOD OF 36 MONTHS

C1.2 Contract Data

Part two - Data provided by the Contractor

Clause	Statement	Data
10.1	The <i>Contractor</i> is (Name): Address Tel No. Fax No.	
11.2(8)	The <i>direct fee percentage</i> is	%
11.2(14)	The following matters will be included in the Risk Register	People Time Scope
11.2(15)	The Service Information for the <i>Contractor's</i> plan is in:	Contractor's plan will be submitted within 2 weeks of the contract date
21.1	The plan identified in the Contract Data is contained in:	Contractor's plan will be submitted within 2 weeks of the contract date
24.1	The key people are: 1 Name: Job: Responsibilities: Qualifications: Experience: 2 Name: Job: Responsibilities: Qualifications: Experience:	

COLLECT, STRIP, ASSESS AND REPAIR WELDING MACHINES ON AN AS AND WHEN REQUIRED BASIS AT ARNOT POWER STATION FOR A PERIOD OF 36 MONTHS

CV's (and further key person's data including CVs) are in _____ .

A	Priced contract with price list		
11.2(12)	The <i>price list</i> is in _____		
11.2(19)	The tendered total of the Prices is	R	_____

COLLECT, STRIP, ASSESS AND REPAIR WELDING MACHINES ON AN AS AND WHEN REQUIRED BASIS AT ARNOT POWER STATION FOR A PERIOD OF 36 MONTHS**PART 2: PRICING DATA****TSC3 Option A**

Document reference	Title	No of pages
C2.1	Pricing assumptions: Option A	2
C2.2	The <i>price list</i>	1

COLLECT, STRIP, ASSESS AND REPAIR WELDING MACHINES ON AN AS AND WHEN REQUIRED BASIS AT ARNOT POWER STATION FOR A PERIOD OF 36 MONTHS

C2.1 Pricing assumptions: Option A

How work is priced and assessed for payment

Clause 11 in NEC3 Term Service Contract (TSC3) core clauses and Option A states:

Identified and defined terms	11	
	11.2	(12) The Price List is the <i>price list</i> unless later changed in accordance with this contract.
		(17) The Price for Services Provided to Date is the total of <ul style="list-style-type: none"> the Price for each lump sum item in the Price List which the <i>Contractor</i> has completed and where a quantity is stated for an item in the Price List, an amount calculated by multiplying the quantity which the <i>Contractor</i> has completed by the rate.
		(19) The Prices are the amounts stated in the Price column of the Price List. Where a quantity is stated for an item in the Price List, the Price is calculated by multiplying the quantity by the rate.

This confirms that Option A is a priced contract where the Prices are derived from a list of items of service which can be priced as lump sums or as expected quantities of service multiplied by a rate or a mix of both.

Function of the Price List

Clause 54.1 in Option A states: "Information in the Price List is not Service Information". This confirms that instructions to do work or how it is to be done are not included in the Price List but in the Service Information. This is further confirmed by Clause 20.1 which states, "The *Contractor* Provides the Service in accordance with the Service Information". Hence the *Contractor* does **not** Provide the Service in accordance with the Price List. The Price List is only a pricing document.

Link to the *Contractor's* plan

Clause 21.4 states "The *Contractor* provides information which shows how each item description on the Price List relates to the operations on each plan which he submits for acceptance". Hence when compiling the *price list*, the tendering contractor needs to develop his first clause 21.2 plan in such a way that operations shown on it can be priced in the *price list* and result in a satisfactory cash flow in terms of clause 11.2(17).

Preparing the *price list*

Before preparing the *price list*, both the *Employer* and tendering contractors should read the TSC3 Guidance Notes pages 14 and 15. In an Option A contract, either Party may have entered items into the *price list* either as a process of offer and acceptance (tendering) or by negotiation depending on the nature of the service to be provided. Alternatively the *Employer*, in his Instructions to Tenderers or in a Tender Schedule, may have listed some items that he requires the *Contractor* to include in the *price list* to be prepared and priced by him.

It is assumed that in preparing or finalising the *price list* the *Contractor*:

- Has taken account of the guidance given in the TSC3 Guidance Notes relevant to Option A;
- Understands the function of the Price List and how work is priced and paid for;
- Is aware of the need to link operations shown in his plan to items shown in the Price List;
- Has listed and priced items in the *price list* which are inclusive of everything necessary and incidental to Providing the Service in accordance with the Service Information, as it was at the time of tender, as well as correct any Defects not caused by an *Employer's* risk;

COLLECT, STRIP, ASSESS AND REPAIR WELDING MACHINES ON AN AS AND WHEN REQUIRED BASIS AT ARNOT POWER STATION FOR A PERIOD OF 36 MONTHS

- Has priced work he decides not to show as a separate item within the Prices or rates of other listed items in order to fulfil the obligation to complete the *service* for the tendered total of the Prices.
- Understands there is no adjustment to items priced as lump sums if the amount, or quantity, of work within that item later turns out to be different to that which the *Contractor* estimated at time of tender. The only basis for a change to the (lump sum) Prices is as a result of a compensation event.

Format of the *price list*

(From the example given in an Appendix within the TSC3 Guidance Notes)

Entries in the first four columns in the *price list* in section C2.2 are made either by the *Employer* or the tendering contractor.

If the *Contractor* is to be paid an amount for the item which is not adjusted if the quantity of work in the item changes, the tendering contractor enters the amount in the Price column only, the Unit, Expected Quantity and Rate columns being left blank.

If the *Contractor* is to be paid an amount for an item of work which is the rate for the work multiplied by the quantity completed, the tendering contractor enters the rate which is then multiplied by the Expected Quantity to produce the Price, which is also entered.

If the *Contractor* is to be paid a Price for an item proportional to the length of time for which a service is provided, a unit of time is stated in the Unit column and the expected length of time (as a quantity of the stated units of time) is stated in the Expected Quantity column.

COLLECT, STRIP, ASSESS AND REPAIR WELDING MACHINES ON AN AS AND WHEN REQUIRED BASIS AT ARNOT POWER STATION FOR A PERIOD OF 36 MONTHS

C2.2 the *price list*

Item nr	Description	Unit	Expected Quantity for 36 months	Rate	Price
1	Strip and assess LINCOLN ELECTRIC INVERTEC V275-S to determine cause of failure.	Ea	72		
2	Components of LINCOLN ELECTRIC INVERTEC V275-S (for repairs)				
2.1	Wrap around cover	Ea	18		
2.2	Assembly				
	Case front assembly	Ea	18		
	Case back assembly	Ea	18		
	Center assembly	Ea	18		
	Choke assembly	Ea	18		
	Switch board and heat sink assembly	Ea	36		
	Output rectifier assembly	Ea	24		
	Main transformer assembly	Ea	36		
2.3	Cooling fans	Ea	24		
2.4	Input rectifier	Ea	24		
2.5	Control PC board	Ea	40		
2.6	Power switch	Ea	40		
2.7	Output terminals	Ea	60		
2.8	Base	Ea	40		
2.9	Thermal shutdown indicator	Ea	40		
2.10	Input filter capacitors	Ea	40		
2.11	Output control switch	Ea	40		
2.12	Local/ Remote switch	Ea	40		
2.13	Mode switch	Ea	40		
2.14	Twist-mate cable plug	Ea	10		

COLLECT, STRIP, ASSESS AND REPAIR WELDING MACHINES ON AN AS AND WHEN REQUIRED BASIS AT ARNOT POWER STATION FOR A PERIOD OF 36 MONTHS

2.15	Remote output control	Ea	16		
2.16	Twist-mate cable receptacle	Ea	10		
2.17	Twist-mate torch adapter	Ea	10		
2.18	Foot amptrol	Ea	18		
2.19	Hand amptrol	Ea	18		
2.20	Hot start switch	Ea	24		
2.21	Power resistor	Ea	20		
3	<u>Safety requirements cost:</u>				
	Safety shoes	Annually	3		
	2 Piece Overalls	Annually	3		
4	<u>Labour (repair work)</u>				
	Electrician	Hr	1440		
	Assistant	Hr	1440		
5	Transportation (to collect and deliver welding machines- capped at 160km per trip)	Km	5760		
The total of the Prices excluding VAT and CPA					

COLLECT, STRIP, ASSESS AND REPAIR WELDING MACHINES ON AN AS AND WHEN REQUIRED BASIS AT ARNOT POWER STATION FOR A PERIOD OF 36 MONTHS

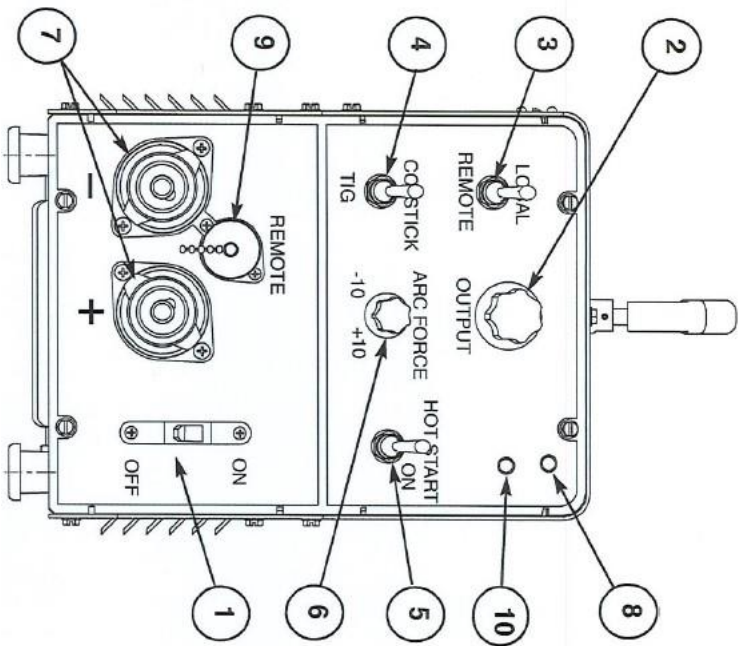
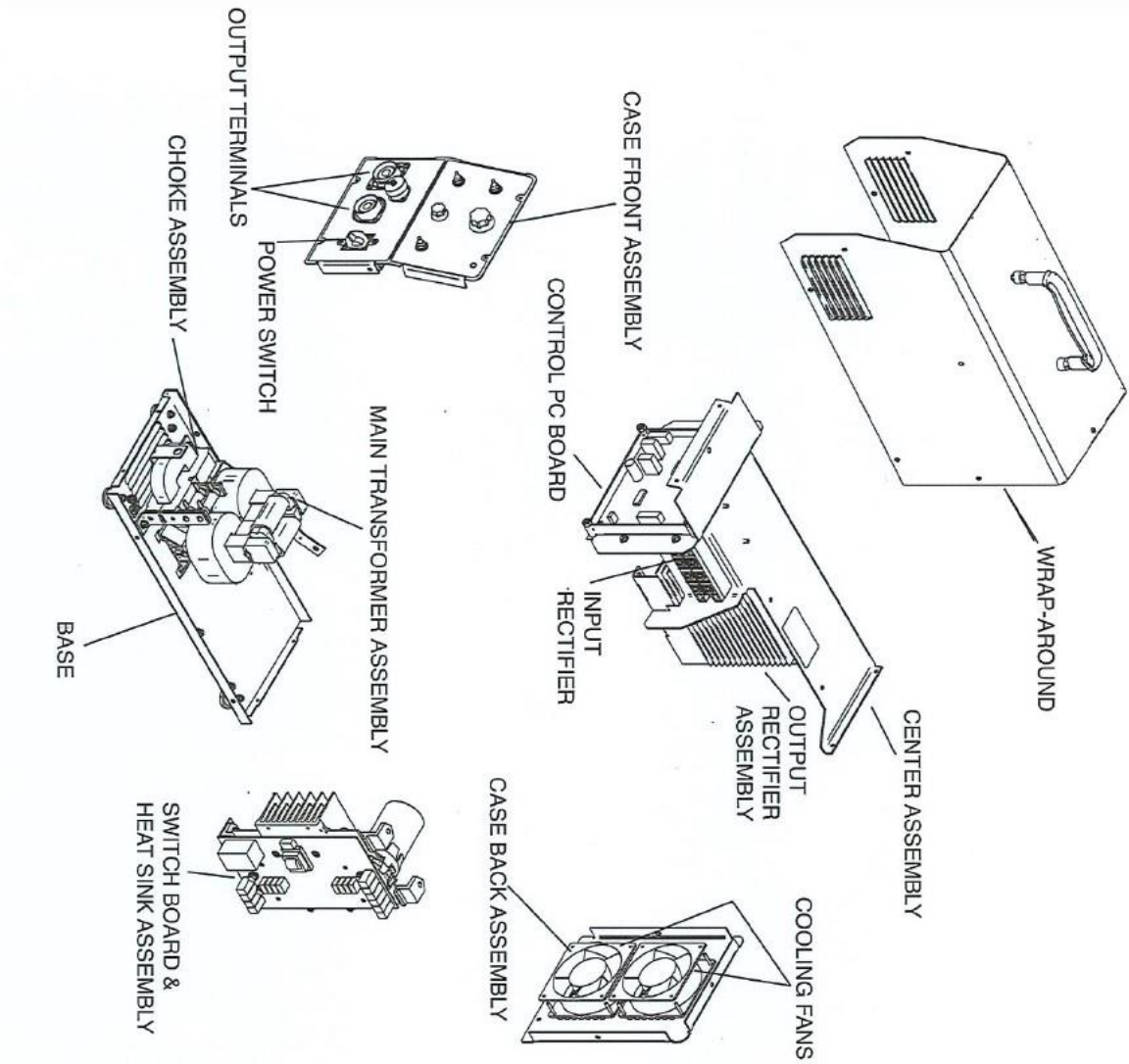

FIGURE B.1 – CASE FRONT CONTROLS.

COLLECT, STRIP, ASSESS AND REPAIR WELDING MACHINES ON AN AS AND WHEN REQUIRED BASIS AT ARNOT POWER STATION FOR A PERIOD OF 36 MONTHS

1	Power Switch
2	Output Control
3	Local/Remote Switch
4	Mode Switch
5	Hot Start
6	Arc Force
7	Output Terminals
8	Thermal Shutdown Indicator
9	6 Pin Remote Receptacle
10	Power Light

COLLECT, STRIP, ASSESS AND REPAIR WELDING MACHINES ON AN AS AND WHEN REQUIRED BASIS AT ARNOT POWER STATION FOR A PERIOD OF 36 MONTHS

PART 3: SCOPE OF WORK

Document reference	Title	No of pages
C3.1	This cover page <i>Employer's Service Information</i>	1
C3.2	<i>Contractor's Service Information</i>	
	Total number of pages	

COLLECT, STRIP, ASSESS AND REPAIR WELDING MACHINES ON AN AS AND WHEN REQUIRED BASIS AT ARNOT POWER STATION FOR A PERIOD OF 36 MONTHS

C3.1: EMPLOYER'S SERVICE INFORMATION

Contents

Part 3: Scope of Work	5
C3.1: Employer's service Information	vi
1 Description of the <i>service</i>	viii
1.1 Executive overview	viii
1.2 <i>Employer's</i> requirements for the <i>service</i>	viii
1.3 Interpretation and terminology	ix
2 Management strategy and start up.	x
2.1 The <i>Contractor's</i> plan for the <i>service</i>	x
2.2 Management meetings	x
2.3 <i>Contractor's</i> management, supervision and key people	x
2.4 Provision of bonds and guarantees	Error! Bookmark not defined.
2.5 Documentation control	x
2.6 Invoicing and payment	x
2.7 Contract change management	xi
2.8 Records of Defined Cost to be kept by the <i>Contractor</i>	xi
2.9 Insurance provided by the <i>Employer</i>	xi
2.10 Training workshops and technology transfer	xi
2.11 Design and supply of Equipment	xi
2.12 Things provided at the end of the <i>service period</i> for the <i>Employer's</i> use	xi
2.12.1 Equipment	xi
2.12.2 Information and other things	xi
2.13 Management of work done by Task Order	xi
3 Health and safety, the environment and quality assurance	xii
3.1 Health and safety risk management	xii
3.2 Environmental constraints and management	xii
3.3 Quality assurance requirements	xii
4 Procurement	xiv
4.1 People	xiv
4.1.1 Minimum requirements of people employed	xiv
4.1.2 BBEE and preferencing scheme	xiv
4.1.3 Accelerated Shared Growth Initiative – South Africa (ASGI-SA)	xiv
4.2 Subcontracting	xiv
4.2.1 Preferred subcontractors	xiv
4.2.2 Subcontract documentation, and assessment of subcontract tenders	xiv
4.2.3 Limitations on subcontracting	xiv
4.2.4 Attendance on subcontractors	xiv
4.3 Plant and Materials	xiv
4.3.1 Specifications	xiv
4.3.2 Correction of defects	xiv
4.3.3 <i>Contractor's</i> procurement of Plant and Materials	xiv
4.3.4 Tests and inspections before delivery	xv
4.3.5 Plant & Materials provided "free issue" by the <i>Employer</i>	xv
4.3.6 Cataloguing requirements	xv
5 Working on the Affected Property	xv
5.1 <i>Employer's</i> site entry and security control, permits, and site regulations	xv
5.2 People restrictions, hours of work, conduct and records	xv
5.3 Health and safety facilities on the Affected Property	xv
5.4 Environmental controls, fauna & flora	xv
5.5 Cooperating with and obtaining acceptance of Others	xv
5.6 Records of <i>Contractor's</i> Equipment	xv
5.7 Equipment provided by the <i>Employer</i>	xv

5.8	Site services and facilities.....	xv
5.8.1	Provided by the <i>Employer</i>	xv
5.8.2	Provided by the <i>Contractor</i>	xv
5.9	Control of noise, dust, water and waste	xvi
5.10	Hook ups to existing works	xvi
5.11	Tests and inspections	xvi
5.11.1	Description of tests and inspections	xvi
5.11.2	Materials facilities and samples for tests and inspections	xvi
6	List of drawings	xvi
6.1	Drawings issued by the <i>Employer</i>	xvi

1 Description of the service

2 Executive overview

Strip, assess, compile a report and repair all welding machines. All repairs to be conducted in line with the maintenance standards. Competent and qualified personnel to be utilized to carry out the task.

3 Employer's requirements for the service

- The transportation of welding machines from Arnot Power Station to the contractor's works.
- Dismantle welding machines and mark all parts with unique numbers relevant to job number.
- Carry out a pre-cleaning assessment.
- Clean all parts/components of the welding machines.
- Carry out a full assessment of the welding machines.
- Compile a report with pricing, Service manager to verify the repair quote and damage.
- The contractor shall notify the service manager when it is no longer viable to repair the machine.
- Where the repair cost exceeds 70% of the cost of a new machine, the contractor must notify the service manager and a new machine shall be supplied upon approval.
- Should the welding machine be found uneconomical to repair the contractor must notify the service manager who will then issue an instruction to scrap the machine.
- The contractor will be required to re-assemble the machine with all the old parts and return the machine to Arnot Power Station.
- The correct PPE must be worn when performing the task.
- Once repairs are done (or machine is scrapped), the welding machines must be transported back to Arnot Power Station.

Item Description: LINCOLN ELECTRIC INVERTEC V275-S



4 Interpretation and terminology

The following abbreviations are used in this Service Information:

Abbreviation	Meaning given to the abbreviation
LV	Low voltage
DC	Direct current
PPE	Personal Protective Equipment
COC	Certificate Of Compliance
EMD	Electrical Maintenance Department
OHS Act	Occupational Health and Safety Act and Regulations, 85 of 1993
SANS	South African National Standard
SABS	South African Bureau Standard

5 Management strategy and start up.

6 The *Contractor's* plan for the *service*

Services would be on an as and when required basis.

7 Management meetings

Regular meetings of a general nature may be convened and chaired by the *Service Manager* as follows:

Overall contract progress and feedback	As and when required to be agreed by both parties.	As agreed when required	Employer rep and supplier
--	--	-------------------------	---------------------------

Title and purpose	Approximate time & interval	Location	Attendance by:
Overall contract progress and feedback	Quarterly on the 2 nd week of that month at ____	Arnot Power Station / Supplier's offices	<i>Employer, Contractor</i>

Meetings of a specialist nature may be convened as specified elsewhere in this Service Information or if not so specified by persons and at times and locations to suit the Parties, the nature and the progress of the *service*. Records of these meetings shall be submitted to the *Service Manager* by the person convening the meeting within five days of the meeting.

All meetings shall be recorded using minutes or a register prepared and circulated by the person who convened the meeting. Such minutes or register shall not be used for the purpose of confirming actions or instructions under the contract as these shall be done separately by the person identified in the *conditions of contract* to carry out such actions or instructions.

8 *Contractor's* management, supervision and key people

The contractor shall submit to the Service manager an organogram showing his people and their lines of authority / communication, in his organisation relevant to the repairs of welding machines.

9 Documentation control

All contractual communications will be in the form of properly compiled letters or forms attached to e mails

Any communication pertaining to the contract shall be between the contractor and the contract manager and/or his/her delegate.

10 Invoicing and payment

Within one week of receiving a payment certificate from the *Service Manager* in terms of core clause 51.1, the *Contractor* provides the *Employer* with a tax invoice showing the amount due for payment equal to that stated in the *Service Manager's* payment certificate.

The *Contractor* shall address the tax invoice to

_____ and include on each invoice the following information:

- Name and address of the *Contractor* and the *Service Manager*;
- The contract number and title;
- *Contractor's* VAT registration number;
- The *Employer's* VAT registration number 4740101508;
- Description of service provided for each item invoiced based on the Price List;
- Total amount invoiced excluding VAT, the VAT and the invoiced amount including VAT;
- (add other as required)

11 Contract change management

N/A

12 Records of Defined Cost to be kept by the *Contractor*

Option A is applicable to this contract and no records of defined costs are required by the contractor

13 Insurance provided by the *Employer*

None provided. Insurance related queries may be directed to the contract buyer.

14 Training workshops and technology transfer

Updated and new technology used by the supplier may be shared with the employer on an ad-hoc basis.

15 Design and supply of Equipment

N/A

16 Things provided at the end of the *service period* for the *Employer's* use

17 Equipment

NONE

18 Information and other things

All OEM Manuals and drawings of supplied equipment
--

19 Management of work done by Task Order

A task order will be issued to the supplier for each task Indicating work to done with the start and end date of the maintenance
--

The Service manager has the format and will complete all the information required

20 Health and safety, the environment and quality assurance

21 Health and safety risk management

In addition to the requirements of the laws governing health and safety, Eskom may have some additional requirements particular to the *service* and the Affected Property for this contract. The text below provides for these being attached as an Annexure to this Service Information. PLEASE ALSO READ CORE CLAUSE 27.4 TOGETHER WITH Z7 IN THE ADDITIONAL CONDITIONS OF CONTRACT TO MAKE SURE THAT WHATEVER IS INCLUDED IN THE ANNEXURE FOLLOWS ON FROM THOSE CLAUSES.

The Divisional/Regional Safety Risk Manager or his representative having jurisdiction over the *service* must provide the relevant safety, health and environmental (SHE) criteria for incorporation into this Service Information. The SHE specification / scope must be signed off by the Divisional/Regional Safety Risk Manager or his representative confirming that the applicable safety criteria have been taken into account.

The Commodity Manager / Buyer must refer the tender to the Divisional/Regional Safety Risk Manager or his representative in order to evaluate against enquiry-specific safety criteria.

The Divisional Safety Risk Managers who will be responsible for the allocation of resources to assist P&SCM with the above processes are as follows:

- Generation: Roley McIntyre
- Transmission: Tony Patterson
- Distribution: Alex Stramrood
- Enterprises: Jace Naidoo
- Corporate: Kerseri Pather

The *Contractor* shall comply with the health and safety requirements contained in Annexure B to this Service Information.

22 Environmental constraints and management

The *Contractor* shall comply with the environmental criteria and constraints stated in Annexure B

23 Quality assurance requirements

24 Quality documents submitted after the contract date

The *Contractor* submits a fully detailed Quality Assurance Programme (QAP) for acceptance by the *Service Manager* within four weeks of the *Contract Date*.

The documents submitted by the *Contractor* shall include the following:

- Copy of the Quality Manual
- Copy of the Quality System Procedure
- Copy of the Contract Quality Management Plan
- Copy of Quality Control Plans
- Copy of the proposed index of the QA/QC, inspection and test records

The *Contractor* will further submit the following documents during the course of the contract:

- Non-conformance reports (NCR's) raised by the *Contractor*
- Notification of any planned changes to the *Contractor's* quality manual, quality system procedures, contract quality management plan or quality plan for acceptance by the *Service Manager* prior to implementation
- Concession/production permit applications and supporting documentation
- Data books and/or data packages

25 Contract quality management plan requirement

The *Contractor* prepares a contract quality management plan that, where appropriate, indicates the following:

- Indicates the interface with the *Contractors* quality system and applicable documents such as procedures and work instructions
- Establishes communication channels between the *Contractor* and the *Service Manager* in respect of quality and the integration of such with the prescribed contract communication channels
- Indicates how specific subcontractors will be monitored
- Identifies items or activities for which quality control plans will be prepared
- Identifies the specifications, drawings and acceptance criteria for material for which quality control plans are not required
- Identifies the areas or processes requiring special controls
- Identifies the *Contractor's* Management Representative and personnel responsible for the control of quality activities and their relationship to the *Contractor's* management structure
- Identifies the documents which are to be submitted to the Service Manager
- Indicates the *Contractor's* quality monitoring programme

The *Contractor* periodically updates the contract quality management plan to reflect changes in any of the above details. The frequency of such updates is determined by the Service Manager but will not be greater than one year.

26 Quality control plan

The *Contractor* quality control plans cover inspection and test proposals for items or activities to be supplied as part of the *works*.

The quality control plan indicates the following as appropriate:

- The identification of the item
- The material
- A list of the sequence of operations including inspections and tests
- The identification of the specification, drawings or procedures for each operation
- The acceptance criteria with reference to the appropriate technical specification, in-house, national or international standard and relevant clause number
- The inspections and tests the *Contractor* has nominated for hold and witness points and it is shown in the Accepted Programme.
- During contract execution no actions to provide the *Works* are implemented at any of the *working areas* before the relevant quality control plans and procedures are accepted by the *Service Manager*.
- Proof of the *Contractor's* personnel competence in terms of Reg 18 (5 and 6) of the OHS Act is submitted to the *Service Manager* for acceptance prior to the commencement of any work on Site and is shown in the Accepted Programme.

Quality control plans with hold and witness points are supplied to the *Service Manager* for his review and acceptance 15 days before the start of each of the following phases and or stages and it is shown in the Accepted Programme:

- i. Investigation phase
- ii. Design and engineering phase
 - Technical clarification stage.
 - Design freeze stage
- iii. Production engineering phase
 - Procurement, fabrication and delivery stage.

- iv. Construction and erection phase.
- v. Commissioning phase
 - Commissioning stage.
- vi. Operational test phase.

27 Procurement

Procurement of any material requirements, other than those as specified in the price list, will only be done by the contract supervisor upon approval of the Service Manager.

28 People

29 Minimum requirements of people employed

All personnel employed by the contractor to provide the service required shall be suitably qualified in the relevant fields to produce such service.

30 BBBEE and preferencing scheme

Please refer to section [4.2](#) of this Works Information

31 Accelerated Shared Growth Initiative – South Africa (ASGI-SA)

Compliance not required.

32 Subcontracting

33 Preferred subcontractors

N/A

34 Subcontract documentation, and assessment of subcontract tenders

N/A

35 Limitations on subcontracting

N/A

36 Attendance on subcontractors

N/A

37 Plant and Materials

38 Specifications

N/A

39 Correction of defects

As per scope of work.

40 Contractor's procurement of Plant and Materials

N/A

41 Tests and inspections before delivery

Acceptance tests to be performed on all repaired and manufacturing equipment

42 Plant & Materials provided “free issue” by the *Employer*

N/A

43 Cataloguing requirements by the *Contractor*

N/A

44 Working on the Affected Property

Protective clothing must be worn at all times

45 *Employer's* site entry and security control, permits, and site regulations

- No taking of pictures allowed on *Employer's* premises without prior approval or consent
- *Contractor* must attend induction before entering premises
- *Contractor* must make pre-arrangements before coming to *Employer's* site to allow *Employer* to make proper arrangements with Security. If no arrangements made, no access will be granted to the *Contractor*
- Contractor must have submitted their safety file with safety department and file passed evaluation before commencement of work

46 People restrictions, hours of work, conduct and records

- Monday – Thursday working time: 07H00 – 16H15
- Fridays working time: 07H00 – 12H00
- Any deliveries or visits outside above timelines, arrangements must be made with an *Employer* in advance

47 Health and safety facilities on the Affected Property

The employer will provide ablution facilities
Drinking water

48 Environmental controls, fauna & flora

N/A

49 Cooperating with and obtaining acceptance of Others

N/A.

50 Records of *Contractor's* Equipment

N/A

51 Equipment provided by the *Employer*

N/A

52 Site services and facilities

53 Provided by the *Employer*

Power, water, waste disposal and ablutions, fire protection and lighting

54 Provided by the *Contractor*

N/A

55 Control of noise, dust, water and waste

Protective clothing to be worn at all times

56 Hook ups to existing works

N/A

57 Tests and inspections

58 Description of tests and inspections

Full Factory Acceptance tests to be performed and witnessed by an Eskom Representative. Test results to be approved by the Eskom Representative prior to delivering the equipment in question. The Contractor must provide the Employer with an official test report on all new and refurbished equipment.

59 Materials facilities and samples for tests and inspections

N/A

60 List of drawings

61 Drawings issued by the *Employer*

This is the list of drawings issued by the *Employer* at or before the Contract Date and which apply to this contract.

Drawing number	Revision	Title